

Extractor250

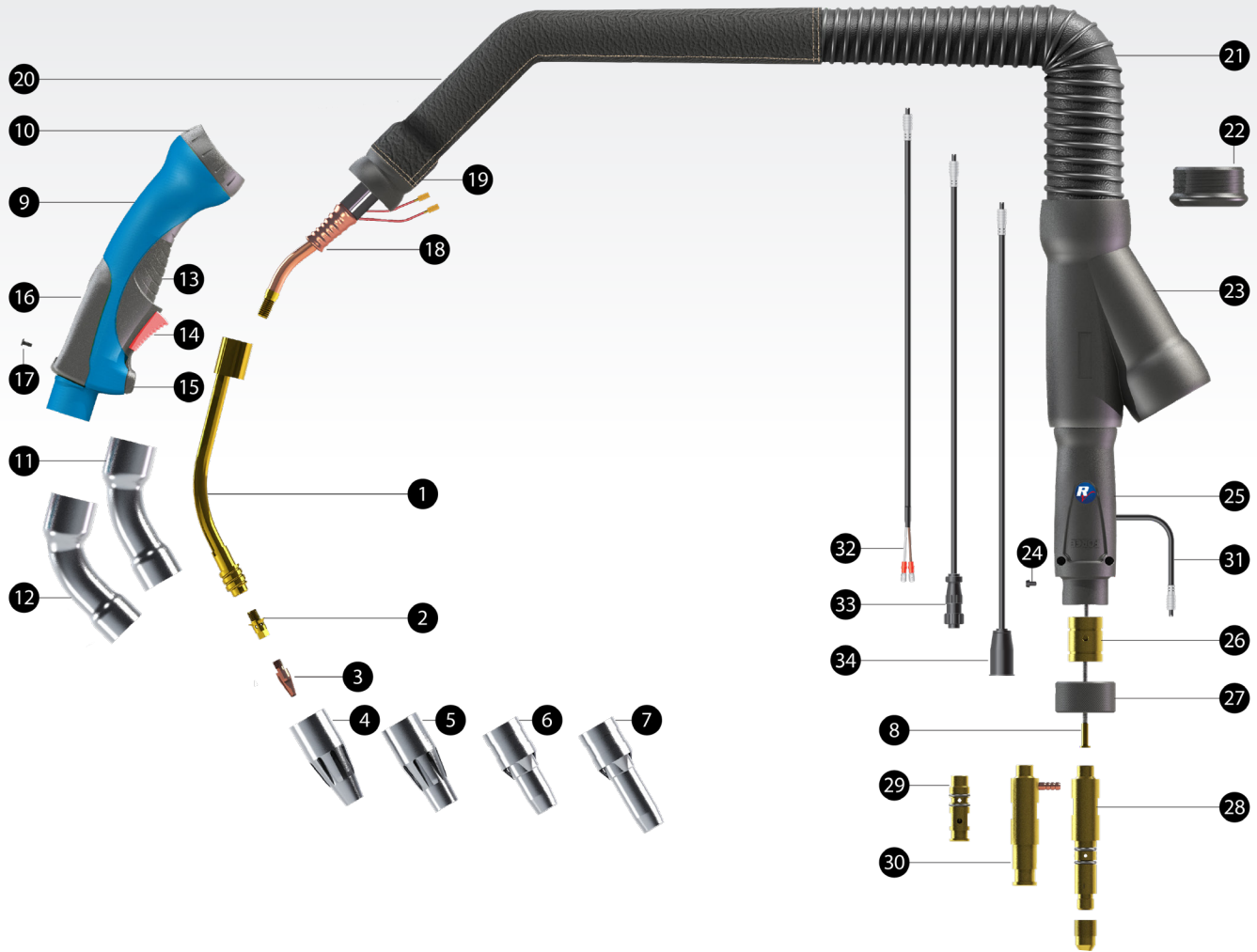

AIR COOLED - 250 AMP
250 AMP, 100% DUTY CYCLE

RoboVent®



PART NUMBER	DESCRIPTION	QTY
- EXG-FM-AC250-3	Extractor250 Fume Gun 3 mtr Air Cooled	
- EXG-FM-AC250-4	Extractor250 Fume Gun, 4 mtr Air Cooled	
- EXG-FM-AC250-5	Extractor250 Fume Gun, 5 mtr Air Cooled	
① EXG-FM-SW-AC	Swanneck Aircooled	1
② EXG-FM-TA	Contact Tip Adapter	10
EXG-FM-ADPT	Tip Holder Extension, 30mm Longer	5
③ EXG-FM-CT-035	Standard Contact Tip .035" (.9mm)	25
EXG-FM-CT-040	Standard Contact Tip .040" (1mm)	25
EXG-FM-CT-045	Standard Contact Tip .045" (1.2mm)	25
EXG-FM-CT-AL-040	Aluminum Contact Tip .040" (1mm)	25
EXG-FM-CT-AL-045	Aluminum Contact Tip .045" (1.2mm)	25
EXG-FM-CT-CU-040	Tri Metal Contact Tip .040" (1mm)	25
EXG-FM-CT-CU-045	Tri Metal Contact Tip .045" (1.2mm)	25
④ EXG-FM-NCE-120	12mm Conical Nozzle (15/32")	2
⑤ EXG-FM-NCE-140	14mm Conical Nozzle (35/64")	2

PART NUMBER	DESCRIPTION	QTY
⑥ EXG-FM-NCE-140-EX	14mm Special Conical Nozzle (35/64")	2
⑦ EXG-FM-NCE-140-SP	14mm Special 30mm Ext. Conical Nozzle (35/64")	2
⑧ EXG-RL-3	Red 3M Liner for .035"-.045" wire	1
EXG-RL-4	Red 4M Liner for .035"-.045" wire	1
EXG-RL-5	Red 5M Liner for .035"-.045" wire	1
⑨ EXG-FM-EH-R	Handle Assembly	1
⑩ EXG-LBN	Locking Nut Bottom	1
⑪ EXG-SW-AC-MN-45	45° Chrome Neck	1
⑫ EXG-SW-AC-MN-60	60° Chrome Neck (coming soon)	1
⑬ EXG-BC	Bottom Cap Trigger Housing	1
⑭ EXG-RT	Trigger	1
EXG-SPG	Trigger switch spring	5
EXG-MS	Trigger Micro Switch	1
⑮ EXG-SH	Suspension Hook	1
⑯ EXG-BLC	Blind Back Cap	1



Extractor250

AIR COOLED - 250 AMP
250 AMP, 100% DUTY CYCLE

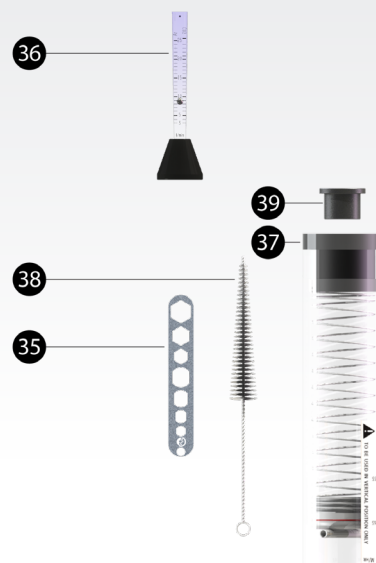

PART NUMBER	DESCRIPTION	QTY
17 EXG-SRW-M4	Screw for back cap/Central Connector Housing	25
18 EXG-FM-CC-3	3 Meter Coax Cable Assembly	1
EXG-FM-CC-4	4 Meter Coax Cable Assembly	1
EXG-FM-CC-5	5 Meter Coax Cable Assembly	1
19 EXG-CS	Ball and Socket Cable support	1
20 EXG-FM-LC-2	Leather Sheathing 30mm with Velcro 2 Meter	1
21 EXG-FM-FCB-3	Tapered Fume Extraction Hose 30-38mm 3 Meter	1
EXG-FM-FCB-4	Tapered Fume Extraction Hose 30-38mm 4 Meter	1
EXG-FM-FCB-5	Tapered Fume Extraction Hose 30-38mm 5 Meter	1
22 EXG-FM-CR	Hose Stiffening Ring (Contra Ring)	1
23 EXG-Y-HOU	Y Connector for Fume Hose	1
24 EXG-SRW-M4X10	Metal Screw M4x10 for USA Connection	10
25 EXG-HOU-US	Housing for Central Connector	1
26 EXG-US-A	Extractor Brass USA Adapter	1

PART NUMBER	DESCRIPTION	QTY
27 EXG-PER	Plastic End Ring for USA Adapter	1
28 EXG-MT	Miller Adapter Pin	1
29 EXG-TWT-N4	Tweco #4 Adapter	1
30 EXG-LT	Lincoln Adapter	2
31 EXG-QCC-EC	Quick Connect End Generic	1
32 EXG-QCC-TW-2ST	Quick Connect cable for Tweco (2ST)	1
33 EXG-QCC-M-4PM	Miller Quick Connect	1
34 EXG-QCC-L-2PL	Lincoln Quick Connect	1
35 EXG-TS	Tool Set (Cleaning Brush and Wrench)	1
36 EXG-GS	Gas Meter	1
37 EXG-AFM	Air Flow Meter	1
38 EXG-CB	Cleaning Brush	1
39 EXG-FM-AFM-ADP	Airflow Meter Adapter for Extractor250 Series	1
EXG-FM-AFM-COMP	Airflow Meter with Extractor250 Adapter Complete	1

Keep Weld Fumes Under Control Without Sacrificing Comfort

Think efficient weld fume control requires sacrificing operator comfort and weld seam quality? Think again. The RoboVent Extractor250 puts high-powered fume extraction into a lightweight, ergonomic fume gun that provides excellent control and maneuverability. At just 2.4 pounds (at 3 feet off the ground), the Extractor250 is as comfortable and easy to handle as your favorite standard weld torch.

- Gas flow and extraction flow are well balanced to give a perfect weld in any position.
- Collects 90-95% of weld fumes at the source, before they enter the welder's breathing zone.
- Rated at 250 amps with a 100% duty cycle with mixed gas and at 280 amps with straight CO₂.
- Ergonomic grip design to reduce hand fatigue and a ball-and-socket joint for greater maneuverability.
- Perfect for large weldments, tight spaces and other environments where welders are highly mobile and source capture of weld fumes is challenging.